



# STAEDEAN Equipment Rental 10.0.42.54 for Dynamics 365 Finance and Dynamics 365 Supply Chain Management (10.0)

Rental Management, Rental Logistics scanning and Rental Mobile Operations

Author: Maarten Kalf, Product Owner



# Table of Contents

<b>1.</b>	<b>General.....</b>	<b>5</b>
1.1	Purpose.....	5
1.2	Audience.....	5
1.3	Available languages.....	5
1.4	Product release information.....	6
1.5	Localizations.....	6
1.6	Data Entities.....	7
1.7	Security.....	7
1.8	Compatibility with other modules.....	7
1.9	License coverage.....	7
1.10	Upgrade from earlier versions.....	8
1.11	Model delivery discontinued.....	8
<b>2.</b>	<b>What's New.....</b>	<b>9</b>
2.1	What's New!?!?.....	9
2.2	Features and enhancements.....	9
2.3	Change requests Rental management.....	13
2.4	Change requests Rental Mobile Operations.....	15
<b>3.</b>	<b>Discontinued features for this release.....</b>	<b>17</b>
3.1	Credit note.....	17
3.2	Rental line editor v1.....	17
3.3	Business object v1.....	17
3.4	Current(old) mobile app.....	17
<b>4.</b>	<b>Bug Fixes.....</b>	<b>18</b>
<b>5.</b>	<b>Known Issues.....</b>	<b>28</b>
<b>6.</b>	<b>Data entities.....</b>	<b>29</b>
6.1	Data entities for import / export.....	29
6.2	Data entities for Business intelligence.....	29
6.3	Data entities for Rental Customer portal.....	29
<b>7.</b>	<b>Configuration keys.....</b>	<b>30</b>
<b>8.</b>	<b>Roles &amp; Security.....</b>	<b>32</b>



<b>9.</b>	<b>Breaking changes</b> .....	<b>33</b>
9.1	Deprecation of the DynaRent Mobile App.....	33
<b>10.</b>	<b>Deprecations</b> .....	<b>34</b>



# Document Information

Title	STAEDEAN Equipment Rental 10.0.42.54 for Dynamics 365 Finance and Dynamics 365 Supply Chain Management (10.0)
Subtitle (Subject)	Rental Management, Rental Logistics scanning and Rental Mobile Operations
Solution Suite	STAEDEAN Equipment Rental
Category	Rental
Author	Maarten Kalf
Published Date	1/31/2025
Status	Final
Comments	

© Copyright STAEDEAN B.V. All rights reserved.

The information in this document is subject to change without notice. No part of this document may be reproduced, stored or transmitted in any form or by any means, electronic or mechanical, for any purpose, without the express written permission of STAEDEAN B.V. STAEDEAN B.V. assumes no liability for any damages incurred, directly or indirectly, from any errors, omissions or discrepancies between the software and the information contained in this document.



# 1. General

## 1.1 Purpose

This document describes the new functionality developed for STAEDEAN Equipment Rental 10.0.42.54 for Dynamics 365 Finance and Dynamics 365 Supply Chain Management (10.0).

The purpose of this release is:

Topic	Yes/ No	Remarks
Upgrade to new Microsoft release	Yes	Microsoft Dynamics 365 Finance and Microsoft Dynamics 365 Supply Chain Management 10 build upon 10.0.39 (for backward compatibility) and validated along with 10.0.42 GA. Refer to this link for more information.
New features	Yes	See chapter 2.1
New D365 functional topics considerations	No	Not applicable
Bug fixes	Yes	See chapter 3.1
Discontinued features	No	Not applicable

## 1.2 Audience

The audience for this document is certified partners selling and implementing as well as customers who have bought the solution.

## 1.3 Available languages

STAEDEAN Rental management is available and supported in the English (EN-US) language. Starting from release 10.0.32.47 the languages German, French, Spanish, Portuguese, Dutch, Italian, Norwegian, and Polish are available to be used next to the English language. Starting from release 10.0.35.48, Swedish language is also available, and starting from release 10.0.37.48, the Danish language is introduced. Any other available language is not supported and needs to be maintained by either the partner or customer.

The STAEDEAN Rental Mobile Operations App is only available in the English (EN-US) language. Other languages are currently not supported.

STAEDEAN Rental Logistics scanning is only available in the English (EN-US) language. Other languages are currently not supported. It is possible to translate the Anywhere labels (labels used within the mobile processes) or label files (label files used within the standard applications). For the translation, either the translation API of Google or Microsoft is used. In order to use one of the translation services you need an API key from either Google\* or Microsoft\*.



## 1.4 Product release information

STAEDEAN Equipment Rental 10.0.42.54 for Dynamics 365 Finance and Dynamics 365 Supply Chain Management (10.0) is built upon D365 version 10.0.39. Since Microsoft maintains a no breaking changes policy, the fact that this release is built on this version means that it can be applied to an environment running on D365 version 10.0.39 or any later version and the application should compile without any issues. However, as we have only functionally validated this version against D365 version 10.0.42 GA, we recommend applying our TI product release on that MS version as well. If you deviate from this (and thus apply the release to a different version), we recommend performing a more thorough round of testing before applying the release to a production environment.

This is summarised in the following table.

Release Date	Release version	Minimum required D365 version	Validated against D365 version	Compatible with D365 version
03/04/2024	10.0.39.51	10.0.36	10.0.39	10.0.36 and above
31/07/2024	10.0.40.52	10.0.37	10.0.40	10.0.37 and above
04/10/2024	10.0.41.53	10.0.38	10.0.41	10.0.38 and above
31/01/2025	10.0.42.54	10.0.39	10.0.42	10.0.39 and above

In case of an Error, STAEDEAN may provide a Hotfix on a reasonable efforts basis in a way it considers appropriate in its discretion. STAEDEAN cannot be obliged to provide Hotfixes if the Client has not deployed the latest release or the Release second to the latest Release and/or is not using a supported version of Microsoft Dynamics.

To ensure our customers can fully leverage the latest enhancements, features, and quality improvements, we are committed to providing increased support by keeping them updated with the most recent releases. Our data indicates that customers on the latest version experience fewer issues and requests, demonstrate greater resilience, and effectively enhance their organizational efficiency.

For more information about our latest available product versions, the latest validated GA-versions from Microsoft as well as the Minimum MS version required, please visit the page: [Knowledge Base - Support - STAEDEAN](#).

## 1.5 Localizations

Available localizations that need to be enabled separately within Dynamics 365 Finance and Dynamics 365 Supply Chain Management to support country-specific requirements do not by default apply for the STAEDEAN Rental Management modules. At this point, STAEDEAN Rental Management does not support these country-specific localizations. In case this is required it needs to be maintained and supported by a local qualified partner that has full insight in the regulations.



## 1.6 Data Entities

This release document contains a list of the data entities that are being supported. Data Entities that are not listed are currently unsupported. The supported data entities may only be used for importing and exporting data. The partner may use these as a foundation to further extend them. STAEDEAN does not have a policy to deliver an import/export data entity for every new functionality.

## 1.7 Security

STAEDEAN does not deliver a full set of duties for the entire STAEDEAN Rental Management solution yet and we do not ensure that any pre-configured roles work in combination with standard Dynamics 365 Finance and Dynamics 365 Supply Chain Management roles and security.

## 1.8 Compatibility with other modules

STAEDEAN Rental Management is compatible with the following solutions for Dynamics 365 Finance and Dynamics 365 Supply Chain Management 10.0.10 or higher:

Rapid Value	Security & Compliance Studio
Advanced Project Management	Action Management
Advanced Maintenance and Service	STAEDEAN Rental Logistics scanning
Advanced Project Planning	STAEDEAN Rental Management BI Easy
Product Engineering	STAEDEAN Rental Management 365 CE
Business Integration Solution	STAEDEAN Rental Management IoT
Connectivity Studio	STAEDEAN Rental Management PowerApps Customer Portal
Dynamics Anywhere	STAEDEAN Rental Management Employee PowerApps

Note: These are optional, and they each require a separate license and are each a separate deliverable.

## 1.9 License coverage

STAEDEAN Rental Management is governed by three licenses that control access to specific functions and features.

Feature	License	Remarks
Rental Order Management	DNRDynaRent	
Business Objects		
Work Order Project Planning		
Utilities		
Field Service PowerApps		
DynaRent BI	DNRBIEntities	
Anywhere for Rental	DNRDynaRentAnywhere	

Important: It is not possible to run STAEDEAN Rental Management without the DNR I license.



## 1.10 Upgrade from earlier versions

*Refer to the installation guide for more details.*

Upgrade of STAEDEAN Rental Management (former DynaRent) D365 onwards is supported via the use of the migration process and tooling as required to upgrade from Microsoft Dynamics 365 Finance and Microsoft Dynamics 365 Supply Chain Management Enterprise Edition.

If you are upgrading from an earlier version than N-1 please read all the related release notes carefully to make sure you are following the required steps.

STAEDEAN cannot assume responsibility for any data corruption or loss resulting from software updates applied without prior testing in a dedicated User Acceptance Testing (UAT) environment. We strongly advise customers and partners to conduct thorough testing in their UAT environment before deploying updates to production.

Should UAT testing fail or if data corruption occurs due to improper upgrade procedures, it is crucial that customers and partners refrain from applying the package to any other environment and instead contact STAEDEAN for assistance.

Please note, any intervention by STAEDEAN to rectify data issues under these circumstances will be subject to charge.

## 1.11 Model delivery discontinued

Models are no longer going to be released from STAEDEAN Rental Management 10.0.30.45 release onwards. If you still require the models, please contact our support team with a business reason.

**If you have installed models from any of the previous releases of STAEDEAN Rental Management, you must remove them before installing STAEDEAN Rental Management 10.0.30.45 or later.**





# 2. What's New

This chapter will contain all features, enhancements and change request added to the three rental products.

## 2.1 What's New!?

Company and product name change:  
As per the 11<sup>th</sup> of July 2024, To-Increase B.V. changed its name to STAEDEAN B.V. With this name change, our products have also changed by name.

STAEDEAN Rental Management  
Is the new name for DynaRent.

STAEDEAN Rental Logistics Scanning  
Is the new name for Anywhere for Rental

STAEDEAN Rental Mobile Operations  
Is the new name for DynaRent Mobile

## 2.2 Features and enhancements

### 2.2.1 Copy return journal lines to new return journal

With this release we extend the return journal functionality with "Transfer Lines", This new feature enables the user to copy lines from a not confirmed return journal to different journal. For example if not all lines are to be returned to the same return warehouse.

The user is able to select the return lines that needs to be transferred to a different journal. After selecting the lines, use the Transfer lines functionality under the "Extended transport" button.

The screenshot shows the software interface for a 'Return' journal. At the top, there is a navigation bar with options like 'Save', 'New', 'Delete', 'Validate', 'Post', 'Functions', 'View postings', 'Unlock', 'Workflow', 'Additional notes', and 'Extended transport'. Below this is a 'Personalize' section with options like 'Always open for editing', 'Personalize this page', and 'Add to workspace'. There are also 'Page options', 'Edit', and 'Share' sections. The main content area shows 'Return | Standard view' and '35835 : Return'. Below this is a 'Journal header details' section and a 'Journal lines' table. The table has columns for 'Selected', 'Date', 'Item number', 'Product name', 'Site', 'Warehouse', and 'Location'. Three rows are visible, with the first and third rows having their 'Selected' checkboxes checked. A red box highlights the 'Selected' column and the 'Transfer lines' option in the 'Extended transport' dropdown menu.

Selected	Date	Item number	Product name	Site	Warehouse	Location
<input checked="" type="checkbox"/>	30-1-2025	450AJ	450AJ	Rental	DEPAL	
<input type="checkbox"/>	30-1-2025	AWPE12M	Aerial Work Platform Electric 12M	Rental	DEPAL	
<input checked="" type="checkbox"/>	30-1-2025	Pipe 11m	Pipe 11m	Rental	DEPAL	



Using the “Transfer lines” button, the system will open the create return journal form. The user can then enter the new return warehouse and click on ok.

After clicking on ok, the system will create the new return journal on the new return warehouse with the lines selected from the starting return journal.

### Create rental return journal

#### Overview

##### IDENTIFICATION

Name

Return

Journal

35837

Description

Return

##### Rental return

Customer account

BAM-01

Return date/time

30-1-2025 00:00:00

Return warehouse

11

Work location code

##### ADDRESS

Delivery address

BAM Nederland

Address

Runnenburg 9  
3981 AZ Bunnik  
NLD

Return | Standard view

### 35837 : Return

Lines Header

#### Journal header details

#### Journal lines

+ New Delete Display dimensions Inventory Functions

Selected	Date	Item number	Product name	Site	Warehouse	Location	Serial number
<input type="checkbox"/>	30-1-2025	450AJ	450AJ	1	11		DEMF015708
<input type="checkbox"/>	30-1-2025	Pipe 11m	Pipe 11m	1	11		

## 2.2.2 Blocked for invoicing directly accessible on invoice forms

In the previous releases we added functionality that can mark rental order line with the checkbox “Blocked for invoicing”. This user could use this value in the normal rental invoicing to not select rental order lines for invoicing if this value was checked.

With this release we have expanded the different rental invoice forms with an actual checkbox, which allows the user add or remove rental order lines that are blocked for invoicing, on the invoice forms.

### Standard non-project rental invoice:

Posting invoice

Arrange Select Printer setup

#### Parameters

##### PARAMETER

Quantity

Packing slip

Posting

Yes

Create rental invoice proposal

N/A

##### COMPLIANCE DOCUMENTS

Prevent sales pack slip/invoice posting

No

Generate product safety data sheet

No

##### PRINT OPTIONS

Print

Current

Print invoice

No

Use print management destination

N/A

##### SETUP

Check credit limit

Balance + Confirmed + Pack...

Credit correction

No

Credit remaining quantity

N/A

##### SUMMARY ORDER

Summary update for

Automatic summary

##### CALCULATION POINT

Calculation date (User time zone)

1-4-2025 00:00:00

Until calculation point

No

##### RENTAL

Include un-invoiced

Yes

Include credits

Yes

Exclude blocked for invoicing

No



## Project Invoice proposal:

Create invoice proposal

**SELECT TRANSACTIONS**

Invoicing method:  Funding source:  Project:

Transaction types:  End date:

Invoice group:  Include un-invoiced:  Yes

Exclude blocked for invoicing:  Yes

Include credits:  No

Invoice date:  Project contract:  Include subprojects:  Yes

Start date:  Financial dimension set:

Calculation date:

## Transfer to project:

Posting invoice

Arrange Select Printer setup

### Parameters

**PARAMETER**  
Quantity:   
Posting:  Yes

**COMPLIANCE DOCUMENTS**  
Prevent sales pack slip/invoice posting:  No  
Generate product safety data sheet:  No

**SETUP**  
Check credit limit:   
Credit correction:  No

**SUMMARY ORDER**  
Summary update for:

**CALCULATION POINT**  
Calculation date (User time zone):   
Invoice date:

Until calculation point:  No  
RENTAL  
Include un-invoiced:  Yes

Include credits:  No  
Exclude blocked for invoicing:  Yes

### 2.2.3 Display serial number and fleet number on rental transfer journal in RLS(A4R)

The rental transfer journal forms in Rental Logistics Scanning are expanded with the business object Serial number and fleet number.

The Rental Transfer Journal lines overview form:

## Rental Transfer Journal

Journal: **35840**

Description: **Rental transfer journal**

	From	Item	Serial number	Fleet number
●	11/L02	Location	017568-3	017568-3

The picking and dropping forms:

## Rental Transfer Journal

Journal: **35840**

Description: **Rental transfer journal**

Whs/Loc: **11 / L02**

Item: **Location / Location / 017568-3 / 017568-3**

Qty/Picked: **1.00 / 0.00 pcs**

Pick:  pcs



### 2.2.4 DFM search on asset availability form

In the previous releases we introduced the new DFM search on multiple forms. At that time the Asset availability form was not considered for adjustment. With this release, the asset availability form is expanded with DFM search functionality.

The screenshot shows the 'Asset availability' form with the following details:

- Filters:** Site (dropdown), Warehouse (depal), Transaction time (30-1-2025 17:41:03).
- Rental types table:**

Rental type	Description	Product number	Item number
AWPE12M	Aerial Work Platform Electric 12M	AWPE12M	AWPE12M
- Settings Panel:**
  - General:**
    - SEARCH COMPONENTS BY ASSEMBLY: Assembly rental type, Assembly product name, Object type (Stand-alone), Available for assembly (Yes).
    - SEARCH ASSEMBLY BY COMPONENT: All components available (No), Current company only (Yes), Current objects only (Yes).
  - DFM search:** Risk Category, OnHoldStatus, Condition (dropdowns).

### 2.2.5 Rental Revenue Accrual reporting table

It is not possible to use standard F&O revenue accrual reporting, as this does not consider rental and the details generated from the rental invoice engine. And the data required for such a report does not exist in a table. Further, each customer will have different requirements for accrual reporting.

Therefore after talking with some customers and our BI specialist, we decided to introduce the Rental Revenue Accrual reporting table. This new table will not be filled by the standard processes, but by a batchjob that you can plan. After completion of the batchjob, you can extract the data to your Datawarehouse solution for your own accrual reporting. If the batchjob is run again, it will first clear the table, before loading it with newly calculated data.

The batchjob can be found at:  
Rental order management – Periodic – Batch revenue accrual

With the month field you can determine until that month in the future that the information from the invoice periods will be calculated for the Revenue accrual reporting table.

- If it is currently January 2025, Selecting January, will return data until the end of January 2025.
- Selecting December, will return data until the end of December 2025.
- Selecting March, will return data until the end of March 2025.

The 'Batch revenue accrual' form includes the following configuration options:

- Parameters:** Month (June), Number of threads (input field).
- Run in the background:**
  - Recurrence: Alerts
  - Batch processing: No
  - Task description: Batch revenue accrual
  - Batch group: (dropdown)
  - Private: No
  - Critical Job: No
  - Monitoring category: Undefined
- Start date:** 31-1-2025 (15:46:57) (GMT+01:00) Amsterdam, Berlin, Bern, Rome, Stockholm, Vienna



With the number of threads, you can define the amount of threads the batchjob should use. The default is 8, as defined by Microsoft. But it is recommended NOT to run it in 8 threads, as this will consume any other batch job that may be running. Recommendation is to always use less threads than what is available for that environment, for example 4.

In Rental order management we have also added a form to display the data. This can be found at: Rental order management – Inquiries – Revenue accrual

Revenue accrual task  
Standard view ▾

Rental order	Start date/time	End date/time	Calendar days	Charged periods	Invoiced quant...	Tier multiplier	Price unit	Rental gross a...	Average gross ...	Discount amo...	Net amount	Average net pr...	Insurance amo...	Consumption ...	Usage discount...	Status	Invoice status
001609	AWPE1... 1,0000000...	27-11-2018 00:00:00	4-12-2018 00:00:00	7	5	1,00	0,00	750,00	150,00	-150,00	600,00	120,00	60,00	0,00	0,00	Delivered	Uninvoiced
001609	AWPE1... 1,0000000...	4-12-2018 00:00:00	11-12-2018 00:00:00	7	5	1,00	0,00	750,00	150,00	-150,00	600,00	120,00	60,00	0,00	0,00	Delivered	Uninvoiced
001609	AWPE1... 1,0000000...	11-12-2018 00:00:00	18-12-2018 00:00:00	7	5	1,00	0,00	750,00	150,00	-150,00	600,00	120,00	60,00	0,00	0,00	Delivered	Uninvoiced

There is also a data entity created to assist with exporting the data. FINRentalInvoiceDetailPeriodAccrualEntity

## 2.3 Change requests Rental management

Functionality added by change requests in the Rental management product.

### 2.3.1 204371 – Saving personalized views on both the transport plan board grids

Microsoft F&O does not support filtering and adding columns to the second grid on a form with more than one grid.

To prevent this, Microsoft added special functions to allow changing the sorting, filtering and adding columns only on list pages, lists and master forms(for example Sales order). Any other form pattern is disallowed from saving personalization, as on the transport plan board.

With our adjustments we have enabled in Rental management on the Transport plan board to save two custom grids.

### 2.3.2 204230 – Transport plan board performance improvement

To increase the performance of drag and dropping tasks on the transport plan board, we have introduced a new parameter. Enable incremental refresh.

Finance and Operations Preview | Work order project planning > Setup > Work order parameters

Standard view ▾

### Work order parameters

- General
- Extended transport
- Graphical planning**
- Business object service agreements
- Number sequences

#### Configure graphical planning

##### Transport plan board

**TASKS**

Internal load task: 01-Load

Internal delivery task: 04-IntDel

Show parent line not completed icon:  Yes

Enable direct delivery:  No

**PERFORMANCE**

Enable incremental refresh:  Yes

When enabled, all actions on the TPB (drag-drop, assign/unassign, status update) refresh only the affected rows/plan board cells instead of the full refresh.



This has a side effect of not seeing other user's changes unless you do a regular Refresh -> All/Planned/Delivery/Load, which is unaffected.

**2.3.3 206074 – Transport plan board pickup task should display BO location**

The pick-up task (work order task type Load) was displaying the customers address on the transport plan board. But there are scenario's an object is moved to a different location, which would mean that the TPB is not showing the right location of the object and the truck driver would drive to the incorrect location.

To ensure the right data is displayed and used in the field service app, we adjusted for the task type Load, that it will now show the current object location, instead of the customers address.

**2.3.4 207085 – WPPWorkordertable – added crosscompany for referencing companyld**

The pick-up task (work order task type Load) was displaying the customers address on the transport plan board. But there are scenario's an object is moved to a different location, which would mean that the TPB is not showing the right location of the object and the truck driver would drive to the incorrect location.

To ensure the right data is displayed and used in the field service app, we adjusted for the task type Load, that it will now show the current object location, instead of the customers address.

**2.3.5 208807 – Option to hide closed periods in transport plan board**

Added functionality that allows the planner to not display closed periods on the transport plan board.

It is depended on the calendar of the selected resources. So if all of the selected resources have a five day calendar, then it will not display the weekend. If there is one resource with a seven day calendar, then it will still display all periods.

Standard view ▾

**Settings**

**PLANNED TASKS**

Resource type

Plan by

Resource group

Resour...

Columns

**Hide closed periods**

No

**UNPLANNED TASKS**

Warehouse

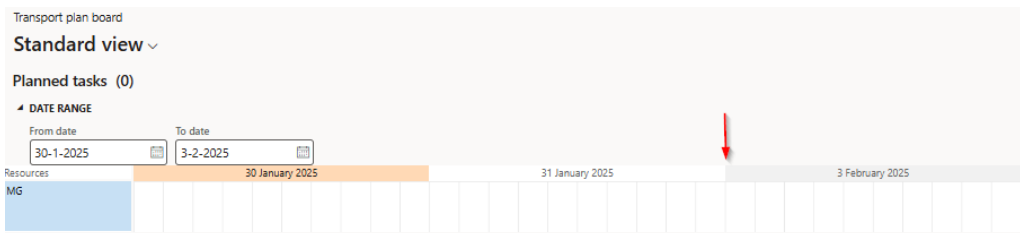

**2.3.6 210224 – Resource planning - resource reassignment concerning dual write**

Added / adjusted functionality to increase the usability for reassigning resources on the work order tasks in combination with the mobile apps.

The planner can change the status back from released to planned, the booking will disappear from the mobile app.

The planner is then able to re-assign the task to a different resource by drag and dropping.

After re-assigning the task, the planned can change the status to released, which will make the booking reappear in the mobile app on the correct date/resource.



## 2.4 Change requests Rental Mobile Operations

Functionality added by change requests in the Rental Mobile Operations Field service app.

### 2.4.1 197029 – Address improvements for Work orders created from the field service app

On the new work order creation form inside the field service app an option has been added for the user to choose if the new work order in F&O should receive the address that the user will enter on the form or that the system will take as address the latest location of the business object.

New Work Order Create - Unsaved Draft Status

**General**

---

Internal note \* ---

Address Same as Asset Location No

Street ---

Street Number ---

Zip Code \* ---

City \* ---

For future releases we are investigating if we can include latitude and longitude in this process.

### 2.4.2 197729 – Adjust quantities and warehouse of necessary items

It was originally only possible to consume or skip the necessary items in the bookings. Starting this release the user has the option to change the quantities and change the warehouse.

Pipe 11m - Unsaved  
Item Checklist

**General**

---

Name \*

Item

Unit

Quantity

Warehouse

Processing Status Consumed Skipped

### 2.4.3 202615 – Added visibility on DFM fields during assembly

Added functionality in the Field service app to display DFM field values during assembly.



### New Assembly Instruction - Saved

Assembly Instruction · Form For Pickup Agent

#### General

Description	<input type="text"/>
Item	<input type="text" value="Generator60Hz"/>
Fleet Number	<input type="text"/>
Serial Number	<input type="text" value="Generator60Hz"/>
Quantity	<input type="text" value="1.00"/>
Picked	<input type="text" value="Yes"/>
Rental Type	<input type="text" value="Generator60Hz"/>

Field	Value
Check A	1
Color	Orange
Size	Large

#### 2.4.4 203780 – Adjust address that needs to be shared with Field service app for Internal load and Internal Delivery

Adjusted the address that is shared to the field service app for the tasks Internal load and Internal Delivery.

Internal load: Instead of the work order address, the last known business object location is shared.

Internal Delivery: Instead of the work order address, the address of the return warehouse is used.

#### 2.4.5 207466 – Check list improvements in the field service app

In the first version of the field service app, the user had to go into each check list to Pass, Fail or skip it. We have now added functionality that the user can update this information in the checklist grid, without having to enter each check list separately.

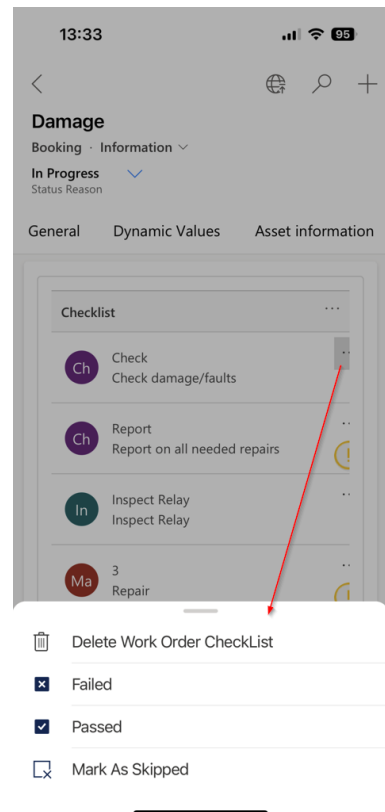





## 3. Discontinued features for this release

### 3.1 Credit note

Starting 2025 the Credit note functionality on the rental order and the Credit approval in the rental order management list page will be discontinued, as this is replaced by the (project) Rental credit wizard.

### 3.2 Rental line editor v1

Depreciation of rental line editor v1 delayed on request of customers. Current plan to deprecate(remove) RLE v1 is either in the July 2025 or October 2025 release, and thus all customers should move from RLE v1 to RLE v2, before RLE 1 is deprecated.

Enabling the rental line editor v2 can be done in the Rental order management parameters. If you have not yet moved to RLE v2, please do this on time and validate if you have customizations, that these keep working or take action.

### 3.3 Business object v1

Deprecation of Business object v1 delayed on request of customers. Current plan to deprecate(remove) BO v1 is either in the July 2025 or October 2025 release, and thus all customers should move from BO v1 to BO v2 before BO v1 is deprecated. Enabling the Business object version 2 can be done as config key.

The reason of switching from business object v1 to the new business object v2 is to improve the performance. The biggest change is that the information of different log tables is stored in one table named BOBObjectCurrentInfo, which stores the "Current" information of the business object.

Don't forget to use the migration tool, which is available when Business object v2 is turned on as config key. The migration tool can be found in the module Utilities, under the header Data and is labelled: Business object view v2 data migration. The migration script brings the information from the different log tables into the table BOBObjectCurrentInfo.

Part of this change, in the previous release, the existing business object v1 is labelled Business object (deprecated). Business object v2 is changed from Business object (preview) to Business objects.

### 3.4 Current(old) mobile app

The current(old) mobile app will be discontinued as part of the July 2025 release and will not be supported anymore after this release. Any issues found after this release will not be addressed and as the app is not customizable, issues cannot be solved by customization.

Until the July 2025 release the current(old) mobile app will be validated against our releases to ensure it continues to operate accordingly. Any urgent issues (Prio 1 release defects) will still be addressed until the July 2025 release. Releases for the current(old) mobile app will only be released on request.

## 4. Bug Fixes

This chapter contains the bug fixes for STAEDEAN Rental management, STAEDEAN Rental Logistics Scanning and STAEDEAN Rental Mobile Operations.

### **134957 - Post costs on Time and Material projects does not work for individual projects**

On a project with WIP posting enabled, user was unable to post the costs directly on the project. The form would not select any transactions. If the user used the periodic function, it would return transactions. It is now possible from the project directly to select and post the costs.

### **174027 - Current address update can lead to undesired address on BO due to time taking for creation of Business object location log**

The date used for the creation of the business object location log with the current address, used to be as follows:

If the document date/time is in the past, the document date/time was used for the location log.

If the document date/time is in the future, the current user date/time was used for the location log.

This would lead in certain scenarios/processes that it would display an incorrect address on the location log.

The code that creates the location log from the different processes in the system has been adjusted, so that in all scenarios it always takes the current date/time when the location log is created.

### **187703 - Rental orders showing products with translations multiple times**

In an earlier release the product name was added to the item dropdown on the rental order lines. It was found for items with multiple translations, that these items will be displayed multiple times, per each translation.

This has been fixed.

### **188922 - Additional fields for consolidated sub rental invoices**

User would receive the error "Object reference not set to an instance of an object" when it would try to consolidate multiple sub rental order with status "Received" in one vendor invoice.

### **191560 - Picking bulk items in Rental logistics scanning that are a combination of two separate rental order lines results in multiple picking actions**

Due to changes in Rental logistics Scanning for visibility of the rental order line type(supplementary/kit lines), some of the lines would be displayed as two picking actions. Adjustments have been made to display these as one again.

### **193482 - The allocation of the KIT discount from KIT item to the child lines gives unexpected result**

In certain scenarios with discount % on the kit and kit lines, some of the kit child lines would receive a different discount %. The following adjustment has been made.

When a user updates the net amount on the KIT line, then the existing code applies. Calculate the discount amount and allocate it to the KIT lines(calculated discount % can be different per line).

When a user update the Discount % of the KIT line, then all KIT child lines will be updated with the same discount %. This will result in KIT net price being recalculated after updating the KIT lines with the new discount %(due to rounding).



**195844 - Pro forma return note doesn't pick up related SalesId**

When the pro forma return note was run from the rental order or work order line details, then the SalesId was not selected in the code, resulting in an error during creation of the pro forma.

**196041 - Inconsistency in rental date setup for Project rental quotation creation**

Some scenarios were found that during the project rental quotation creation the rental date setup not always was followed correctly, resulting in unexpected, prefilled dates on the project rental quotation form.

**196059 - Rental credit wizard - Incorrect invoice periods generated**

In some cases, after performing the rental credit wizard for multiple rental order invoice periods, the Rental invoice details would display these as one line.

**197108 - Filter on customer contacts on work order quotation form**

On the work order quotation form, after selecting the customer, the filter on the contact person would still display all contact persons from the system. This is adjusted to only show the contact persons from the selected customer.

**197286 - Rental transfer order allows even if pick BO from a different warehouse**

Adjustment made that the rental transfer order validates the from warehouse to the current warehouse on the business object.

**197466 - Wrong quantity calculation in Component line editor**

The component line editor in the assembly journal used from the supplementary items the quantity limit as source, instead of the Supplementary quantity.

**197533 - User able to assign the delivered business object and able to deliver it again**

A case was found that the user was able to deliver a business object more than once, with the "Rental posting policies" "Allow overlapping transactions" disabled. A fix has been applied for this.

**197765 - Assign buttons on rental quotation must not be active for bulk lines**

It appeared the assign business object buttons on the rental quote were active for bulk lines.

**197810 - Business object and Prospect details are not showing correctly from the Rental quotation line search form.**

Enter a rental quotation from the rental quotation line search form and assign an object. If you then return to the rental quotation line search form, it would display incorrect business object and prospect details, as wrong record was displayed.

**198058 - Start & End date of the created work order are not fetched correctly based on Work order template**

Work orders created from a work order template setup with date setup Work order date, would be created based on the creation of the work order, not based on the start date and end date fields on the work order creation form.

**198250 - Enhancement data entity for usage-driven CBB**

The following data entities are extended to support Consumption price type.

STAEDEAN Rental Management consumption allowance tier entity

STAEDEAN Rental Management consumption price tier entity



**198251 - No validation on "Cleaned" checkbox**

Added validation with warning if the checkbox Cleaned is updated and there is still a quantity larger than zero in the current quantity field.

**198252 - Current quantity not updated by fuel transactions**

For posting fuel transactions of type Refuel, the fuel tank is now updated in the following way:

Updating of the fuel tank on business object:

When the method is Add

- Update the fuel tank status Cleaned checkbox to No
- Update the quantity field with the value in the capacity field

When the method is Current

- Update the fuel tank status Cleaned checkbox to No
- Update the quantity field with the quantity field on the fuel transaction

When the method is Removed

- Update the fuel tank status Cleaned checkbox to No
- Update the quantity field to zero

**198254 - Add validation that fuel transaction quantity cannot exceed limit of tank**

Added validation that the posted fuel transaction, which is updated on the fuel tank cannot be larger than the fuel tank capacity field.

**198256 - Object fuel tank not updated when refuel with lower quality**

When posting a fuel transaction that has a lower quality than the fuel in the fuel tank, then the fuel in the fuel tank must be updated to the value from the fuel transaction.

**198257 - Customer fuel type not validated for country**

Added validation with warning "Selected fuel is not allowed for the customer's main address" if the fuel selected in the preferred fuel type on the customer is not existing in the fuel country quality table.

**198319 - "Site" not filled in on WO quotation even when "Warehouse" is filled in**

On the work order quotation line, the site field would not be updated when the warehouse field was updated.

**198453 - Fields name should be changed**

The fields DNRisTechnicalExchange and DNRRLEinitialised were missing labels, that has been fixed.

**198455 - Clicking on returned object in TPB gives stack trace**

If the user would click on the returned business object in the transport plan board, the user would receive a Stack trace: Calling wait or detach before calling run. This is resolved.

**198568 - Fuel allowed per country not validated**

The fuel country quality table contains the setup on which fuel is allowed per country. During creation on the fuel tank and posting of a fuel transaction, this table was not validated.

**198588 - No warning when fuel type of assigned object is lower than requested fuel type**

Added warning/validation when the fuel type of the assigned object is lower than the requested fuel type on the rental order line.

**199846 - Hide unused fields on the delivery journal header**

Adjusted the delivery journal head to hide unused fields.



**200187 - Address fast tab gone from BO**

With the development of Business object locations functionality, the address tab was connected to the config key, making it not visible when the config key was turned off.

**200462 - Existing address fields(Street, City, Country...) are not missing on current address tab**

With the development of business object locations, the site, warehouse and location were added to the address tab. But the address information itself was not visible anymore, these are back again.

**200624 - Work order quotations creates unwanted item lines**

The work order quotations created from a work order template would automatically receive lines for required items, although these were not setup for the tasks on the work order template.

**201234 - Dutch label issues**

As we use the Microsoft translation service, some labels were affected incorrectly, these labels for these fields are now fixed.

**201429 - Field service app is not properly displaying the address following the setup in F&O**

Adjustments have been made to show the address in the Field service app as it is used in F&O.

**201457 - Technical exchange CBB: The replacement line takes the new RAG, instead of the original RAG from the exchanged line.**

When the technical exchange is executed the newly created rental order line does not receive the same RAG, but the RAG that is now active. This has been adjusted.

**201517 - Incorrect default RAG displayed on other type of agreements for different periods**

The system was using the current date for displaying the default RAG values/tiers on the other lower type of agreements. This resulted in displaying the default RAG values/tiers of this year on the RAG for next years RAG and order. Adjusted the code to validate for the current RAG that the default agreement covers that start date.

**201556 - Unidentified transactions are displayed in the Business object graphical availability**

In the previous releases we added a range of new rental transactions, to be displayed on the business object graphical availability. Some small bugs were found were these were incorrectly displayed.

**201557 - Rental transfers order is displayed in the beginning of the view, after receive is posted on Business object availability**

Rental transfer order was originally not displayed on the business object availability. These have been added with some adjustments. This had led to the unexpected result that the box of an in the past received rental transfer order was being displayed on the first day.

**201693 - Filter updated on service plan board to previous value**

After changing the filter on the SPB and performing an action, in some scenario's it would reset the filter on the old value. This related to how the filtering with Microsoft is used, adjustments made to correctly update it.

**201787 - Prevent disabling of the fuel tank toggle on the business object if there is still fuel, or if it is assigned on a RO line**

If the fuel tank is setup with fuel, the system still allowed to uncheck the "Enable fuel tank" on the business object. And when the business object is delivered to a rental order line. This is now prevented.



**201848 - Off-rent fuel transaction and on-rent credit fuel transaction dates do not match**

Creation of the off-rent fuel transaction created an on-rent fuel transaction credit, the date on this transaction was not created with the same date as on the off-rent fuel transaction.

**202141 - Validate final meter reading doesn't work and allow to invoice the final project invoice for CBB without meter readings**

A scenario was missed with project invoicing that the final invoice for a rental order line with CCB could be posted without the final meter reading.

**202142 - BO Location is not updated when BO is scanned during picking(not pre-assigned on TO/RO line)**

During scanning in the picking process in Rental logistics Scanning, the new location was not updated on the business object.

**202272 - Credit Exposure - Packing slip posted when error/block on Credit limit**

Posting the packing slip with "Balance + confirmed + packing slip" while there isn't not enough limit would result in an error as expected and would create a record in the Credit management hold list. But the packing slip was still posted, this should have been prevented.

**202275 - Bulk line items data from the delivery and return journal mapped incorrectly to the Rental Mobile Operations Transportation app**

Items from F&O were incorrectly displayed in the Mobile transportation app.

**202546 - Ad-hoc BO transfer is not working using A4R Rental transfer journal menu**

As there was a difference in the validation for the available quantity between F&O and Rental logistics scanning, an error would appear. This is adjusted to follow the same validation as in F&O.

**202548 - Qty to move must be auto populated to 1 for serialized BO in Ad-hoc rental transfer journal in Rental logistics scanning**

The form would display an empty field, and the user had to update this to one every time. This is now pre-filled with the value one.

**202596 - On the PRQ and RQ the consumption details are not displayed in the rental totals**

Originally it was not planned to display consumption details on the rental totals on the PRQ and RQ. But after adding estimated consumption to CBB, it is logical to display this. But was not included.

**203063 - Closed days on transport plan board not shown correctly per resource**

Related to other development, the transport plan board would display on all resources the closed days, based on the first resource. Instead of displaying it based on the setup on each resource.

**203418 - Automatic disassemble journal is not working without work order template**

System would not allow to process the automatic disassembly journal(through return process) without the work order template ID configured on the component journal.

**203533 - Total consumption amount calculation incorrect with CBB = Last invoice**

On the rental invoice details the total consumption amount was incorrectly calculated / displayed when multiple lines with different consumption groups were present.



**203683 - RORRentalLine.RORGetParentLine() - Casting error on WPPWorkOrderStatusUpdate and other objects**

On a few relations between the rental order and the work order, the parent of the salesline was not correctly shared, resulting in the error.

**203778 - When running periodic task 'Create project invoice proposals' with the calculation date that falls in the next invoice period(but before the End date of invoice period) the system creates \$0 invoices**

Adjustments made to ensure no Project invoice proposals are created with a zero value.

**203782 - Unable to scroll in the pop-up transport and service plan board**

A cosmetic bug, that prevented the user from scrolling inside the right click pop-up.

**204192 - Error message on going to related Assembly journal from business object graphical view**

Fixed an error that would appear if the user went from the business object graphical view to the assembly journal.

**204232 - Additional notes are not displayed in TPB**

As part of the new mobile the amount of character was increased for the additional notes, which caused them to be visible on the Transport plan board. This has been fixed.

**204277 - Sub-rental changing rate codes, system stops recalculating price tiers after changing from minutes to day, week and month**

An issue within the rounding would stop the recalculation in some scenarios.

**204310 - "Not Delivered" field is not getting updated in relevant outbound information page for undelivered items**

Due to design changes during development, this field was missed for update in the delivery process.

**204402 - Invoice period can be re-invoiced after credit wizard process Re-invoice = No , Full credit**

In certain scenarios with period selection, the user was still able to re-invoice the periods, after the credit wizard process with re-invoice = no. Adjustments made to prevent this.

**204470 - Getting Dual write core error while trying to post journal from FSE**

Resolved dual write errors that appeared during posting of journals from the field service app.

**204726 - Change date function on the RO header doesn't recalculate the CBB price tiers**

A scenario was found when changing the date on the rental order header, that would change the order length from long term to short term, that the CBB price tiers on the line were not recalculated.

**204734 - Unable to sub rent or sell a business object to another legal entity**

Adjusted the process to allow sub-renting or selling a business object to another legal entity.

**204839 - Delivery invoiced twice when the first invoice is credited through the rental credit wizard**

An issue was found after the first period was selected for credit in the credit wizard, during invoicing of the invoice period with include un-invoiced and include credits.

**205116 - Kit prices not updated on the project rental quotation lines after change date**

There was an issue with the rental gross amount calculation on the project rental quotation, which caused that the kit prices were not always updated on the PRQ.



**205155 - When populating a discount on the main kit the discount is not applied to the line(s)**

In the previous release adjustments were made to support CBB within the kit structure, this seemed to have broken the discount update to the kit lines.

**205175 - If the actual/estimated consumption is equal to the price tiers, system fetch the next tiers**

On a created RO line with estimated consumption. Which value is equal to the consumption To price tier, the system would take the next price tier, instead of the previous price tier.

**205176 - Error thrown unexpectedly early while modifying dates in the change date dialog**

Adjustments made in the previous release, would give an earlier warning when modifying dates, on request from multiple customers, this process is adjusted. The validation is moved from the expected off-rent date field to the Ok button.

**205183 - Estimated consumption on the RO line reverts to default value when changing dates on the ROL**

The change date function unintentionally triggered the Estimated consumption function on the rental order header, with as result that the value on the line was updated.

**205243 - Total Amount wrong on the posted invoices**

An issue found within the pre-invoice check batch job functionality. It would not always correctly cleanup the records in the Markuptranstable. Which on certain occasions led to the result that it was also invoiced, when the invoice was run. Resulting in invoicing double amounts for charges.

**205571 - Project rental invoice: Insurance is not posted for the CBB price.**

Within the project rental invoice process, the insurance was not posted for the CBB prices. The total charges amount didn't include insurance for the usage-driven price.

**205758 - Unbalanced ttsbegin/ttscomit for rental totals in case consumption price is enabled on rental.**

Issue was caused by a merging error, this has been resolved.

**205776 - Rental transaction not removed when unassigning an business object**

In the previous release we added functionality that generate serial numbers and business objects earlier in the production process. This issue was introduced by these changes.

**205881 - Mass return - Error during scanning of Barcode**

Error was the result of configuration of Rental logistics scanning.

**205902 - Object availability overview not updated correctly after losing/closing quotation**

If the Project rental quote was lost or cancelled, then the rental transaction status was not updated from active to closed. Which led to showing the object still unavailable in the availability overview.

**205929 - Fuel Invoice with final invoice not working correctly**

Functionality was created that when a rental type is setup with "Invoice fuel at final invoice", that the fuel transaction was invoiced for zero. And that at the final invoice, only was invoiced what was actually used. In our on-rent fuel transaction creation and posting process, the update from posting the fuel transactions, it would receive a price from the trade agreement, leading to the result that the fuel was still invoiced in the first invoice.





**206077 - Picking lists not generated during multiple picking list generation from the RO / SO**

While generating multiple picking lists, if the user would remove one of the to be generated picking lists, then the system would not create the picking lists.

**206154 - Picking object to sell on a salesline gives unexpected rental asset status error**

Last year we worked on the rental asset status validation during picking. A scenario with picking an object to sell on the sales line was missed. This is now working.

**206155 - Required items on spare parts are not created when WO is created from rental order**

Due to an issue in the query, the required items were not created when the work order was created from a rental order

**206290 - Return warehouse on an order is cleared after posting the RQI**

Bug related to recent business object location development. If this config key was not enabled, the return warehouse in the Return quality inspection process was cleared.

**206437 - Items related data deleted form related outbound information table lines in a scenario when the delivery journal is deleted but the line must not be deleted**

In the deletion of the delivery journal, the connection to the rental order line was removed, which led to not showing the item information on the Outbound information table, for the related lines. Adjustments made to display this information.

**206443 - Outbound list posted for full qty instead of qty to deliver when posted for multiple lines simultaneously**

Scenario was missed during testing. Process has been adjusted and corrected quantity is now posted.

**206571 - Error in processing transport tasks in the app when related journal is open it the F&O**

Processing transport tasks in the app when related journal is open was blocked. As it only required to retrieve information, the entity was adjusted to read only, this way the user is not blocked.

**206586 - Fuel Attributes are not visible during picking in Anywhere for Rental**

This issue is related to 191560. We had to adjust the design as these were conflicting with each other. Bulk lines will be shown as one line, as long as there are not attributes assigned to the lines. If their bulk lines contain attributes, then these will be shown separately.

**207496 - Database sync error after installing October 2024 release and switching off the Business Object Location configuration key**

Adjustments made to ensure no database sync error will appear when the BO locations config key is off.

**207704 - When trying to change the warehouse on a rental order with a back 2 back purchase order an error message is thrown**

Adjustments made in the past for the sub-rental order connection to the rental order, were blocking the process when trying to change the warehouse on a rental order with connected purchase order. Adjustment made to ensure the unmarking/marking process with purchase orders is available.

**207785 - The fill cache table is not updated after return journal confirmation with journal information**

A scenario was found that the fill cache table for Mass return was not updated after return journal confirmation. This has been fixed.



**207885 - Validating an item arrival journal results in an error when the source is a regular transfer order**

Issue caused by regression of new business object location functionality. The item arrival journal would receive an error when the source was a standard transfer order. This has been resolved.

**208191 - Site/Warehouse/Location not displayed properly in Assign BO form and BO availability form based on different filters**

An adjustment to the query has been made to solve the issue that something the site/warehouse/location was not displayed on the assign bo and bo availability form.

**208356 - Improve performance on BO availability form**

Two adjustments have been made to increase the performance of the business object availability form.

1. If the BO availability form is opened directly, and not from a rental order, then the form will not load any data. Only after updating the rental type and refresh, the data will be loaded.
2. In the parameters added option to decide if you want to use rental asset status on the business object availability form or not. Enabling this parameter will have effect on the performance.

**208611 - Rental code prevents quotation copy header to line field extension**

The extension on DNRSalesQuotationToLineFieldClass\_Extension.DNREvent\_getFieldDescriptionDelegate() is adjusted.

**208635 - CE database rule is blocking work order completion from F&O (Use in mobile=off)**

Resolved a dual write issue between F&O and Field service app.

**209144 - Updating the price in the RLE not possible when there is an exchanged line in a kit**

Issue was caused by new development added in last release that updates the kit price, based on the line status.

**209152 - Sub rental order invoice having some display issues**

The rental invoice details on the sub rental order invoice would not always display the tier multiplier and price unit. This has been fixed.

**209460 - Only one resource is able to see necessary item in Field service app**

Bookings can be looked at with multiple users, but only one user would see the necessary items. Both users can now see this information.

**210297 - Customer not getting visible in Pickup Request in Transport App in Offline mode**

Issue was happening due to MS limitation on the field service app. Adjustments have been made to make this still available.

**210390 - Scanned Spare part is not appearing in Spare Parts List in Field Service App**

Scanned spare parts were not added to the list after saving in the Field service app. Adjustments made in the app to fix this.

**210604 - Business object availability> date range are not working based on parameters**

Adjustments made on the business object availability form to improve the performance, removed some requested features. New adjustments have been made to still support the requested features, without effecting the performance.



**210647 - Update conflict while importing lines through the Rental consumption line entity**

A very specific scenario was giving an error while using the rental consumption line entity while importing data. This is resolved.

**210698 - Address is not available in Asset (FS app)**

On the asset page in the field service app, the map was visible, but no separate fields for the address. This is adjusted to also display the address separately.

**210752 - The name of the work order created from FS app is incorrect**

Work orders created from the field service app in F&O would receive an incorrect name, as the incorrect relation for the name was setup.

**210777 - UI Improvement from Mobile**

In both Mobile apps, in some cases, after adding the signature and confirming the summary, the app would freeze.

**210819 - Note is not updated between FS app and F&O until the work order status is changed**

The notes from the work order were not getting updated with a work order status changed, this process has been adjusted so that the entity will update the notes also without a work order status change.

**211300 - German Label file contains weird numbers**

For our label translations we use the MS automated dynamic translation service, and it seems something went wrong. This has been fixed.

**212346 - When updating the quantity in RLE for the kit, the qty of the lines seem to be not updated directly**

An issue with refreshing of the rental order lines, were it seemed the applied change did not happen. After manually refreshing it would show correctly. Adjustments made to show it correctly directly after the adjustment.



## 5. Known Issues

### **STAEDEAN Rental Management**

NOTE: Microsoft is investing heavily in Dual-Write as synchronisation tool instead on Data Integrator, it is Microsoft's advice to use Dual-Write. Dual-Write is a near real-time (1-10 seconds) solution and Data Integrator a batch-driven solution which is always slower in displaying information, however Dual-Write can still be "slow" as some synchronisations take a minimum of 5 seconds, which can't be made faster.

Also, Dual-Write has its limitations, known issues and unsupported features which are described in the Mapping Concept pages of Dual-Write, see the Dual-write home page - Finance & Operations | Dynamics 365 | Microsoft Learn.

NOTE: Microsoft is continuously adding new features in the application directly and via Feature Management. Sometimes these are public preview and will be made generally available in future releases, in other cases, they are already general available, and you have the choice to activate them.

Currently, we are not testing compatibility with all new features or combinations.

Once a feature is enabled at the customer environment and in case of any issues or questions related to new standard features and our solutions, kindly contact us via STAEDEAN support.

#### *Known issues for the release*

#### **Microsoft feature: Match the detail for vendor invoices**

Unfortunately, it was discovered during testing that the sub-rental invoicing with variances functionality which was released with number 109281 in the 10.0.13 release is affected by Microsoft's feature "Match the detail for vendor invoices". Please keep this feature turned off if you're using the sub-rental invoicing with variances functionality. Microsoft has received negative feedback about this feature and will be redesigning it. Therefore we will not be working on compatibility until the Microsoft redesign is completed.

### **STAEDEAN Rental Mobile Operations**

o Depending on your licensing model, you might encounter an exception when synchronizing the data from Finance and Operations to the local device, stating "The per app limit for storage has been exceeded. Reduce the amount of data to be stored or use Clear Data to free up space." If this is the case, please review your licensing model and purchase additional licenses as required.

o Sometimes, even though resource is configured correctly, first time configuration on mobile app triggers message saying that resource must be filled in. This is not a consistent repro. Try to create Work order from D365 FO and then try the same on mobile app, you can get rid of this ad-hoc issue.



## 6. Data entities

### 6.1 Data entities for import / export

Please refer to installation guide for technical details.

Changes for this release

The rental agreement entities have been updated for consumption based billing.

Known issues for this release

Rental shop card entity- shop card activation along with new card import does not work in this version. The rental shop cards should be imported in inactive mode and then activated manually.

### 6.2 Data entities for Business intelligence

*Refer to installation guide for technical details.*

Refer to installation guide for technical details.

Known issues for the release

Some entities contain fields of the type datetime. Finance and Operations stores the information of these fields as UTC datetime in the SQL database table. To be able to transform this datetime to local time, an extra field is available in the SQL table containing the time zone id. Due to a technical limitation this information is not yet available and will be transformed in the BI data warehouse to a local time, based on a fixed value. It is expected that this issue will be solved in the next release.

Changes for this release

Below a list with the major changes and impact of the modified data entities for this release. For further information you can contact our support department to provide additional services and/or training to assist in case needed.

### 6.3 Data entities for Rental Customer portal

Setting up/implementing the 'Rental Customer Portal' requires the setup of data integration projects to synchronize data from Finance and Operations to Dataverse.

One of the data integration projects that needs to be set up is the data integration project for synchronizing sales invoice line data. A data integration project uses a data entity to fetch data from Finance and Operations.

If you have a data integration project set up for synchronizing sales invoice line data and this data integration project makes use of the 'SalesInvoiceLineV2' data entity (i.e., 'Sales invoice lines V2'), then please create a new data integration project that makes use of the 'SalesInvoiceLineV3' data entity (i.e., 'Sales invoice lines V3'), as the 'SalesInvoiceLineV2' data entity is not supported anymore.

Please refer to the STAEDAN Rental Management Customer Portal release notes for further details.



## 7. Configuration keys

This chapter contains a summary of all the configuration keys that are included in this release, along with the functionality they implement. If you are not using the functionality, please disable the corresponding configuration key. More information on how to disable configuration keys can be found [here](#).

Configuration key	Purpose	Recommendation
STAEDEAN Rental Management CE Integration	Supports the STAEDEAN Rental Management CE product and functionality	Disable if the STAEDEAN Rental Management CE product is not being used
STAEDEAN Rental Management PowerApps	Supports the STAEDEAN Rental Management Mobile product and functionality	Disable if the STAEDEAN Rental Management Mobile product is not being used
Rental customer portal	Supports the STAEDEAN Rental Management Customer portal product and functionality	Disable if the STAEDEAN Rental Management Customer portal product is not being used
Rental data entities (BI)	Support the STAEDEAN Rental Management BI product and functionality	Disable if the STAEDEAN Rental Management BI product is not being used
Keep deleted DynaRent * objects	Objects that have been deprecated between certain periods	Disable after usage of the deprecations have been refactored
Deprecated features	Objects that have been deprecated	Disable after usage of the deprecations have been refactored
On-hand rental inventory	Support the on-hand rental inventory functionality	Enable
Fleet number	Support the fleet number functionality	Enable
Additional notes	Additional notes on work orders	Enable
Rental dates	Supports the rental dates functionality	Enable
Rental invoicing	Supports the rental invoicing functionality	Enable
Rental shop	Supports the rental shop functionality	Enable
Tax matrix	Support the tax matrix functionality	Enable
Assign serial	Supports the assign serial functionality	Only enable when you want to use this functionality (by default it is disabled)
Anywhere for Rental	Supports Rental specific Anywhere applications	Only enable when you want to use this functionality (by default it is disabled)
Consumption-based billing	Supports consumption-based billing functionality	Only enable when you want to use this functionality (by default it is disabled)
Work Order Quotation	Supports work order quotation functionality	Only enable when you want to use this functionality (by default it is disabled)
Business object components	Supports the business object components functionality	Only enable when you want to use this functionality (by default it is disabled)



Business object location	Supports the business object locations functionality	Only enable when you want to use this functionality (by default it is disabled)
Credit exposure	Supports the credit exposure functionality	Only enable when you want to use this functionality (by default it is disabled)
Fuel Management	Supports the fuel management functionality	Only enable when you want to use this functionality (by default it is disabled)



# 8. Roles & Security

This chapter contains the latest information around the roles and security within this release. This release contains a couple of specific roles that we have identified. These roles and related security can be used as foundation for extend it to your own needs. In this release, we do not deliver full duties and privileges for the entire STAEDDEAN Rental Management solution yet and we do not assure that any pre-configured roles work in combination with standard Dynamics 365 Finance and Dynamics 365 Supply Chain Management roles and security. In the upcoming releases, we will focus on this area in particular by leveraging the standard Dynamics D365 for Finance and Operations security features.

## Roles overview

Below is an overview of the available STAEDDEAN Rental Management roles in this release:

Role name	Description
Administrator	Administrator
DynaRent User	Simple User
Rental Administrator	Administrator at the rental department
Rental Clerk	Operational rental employee
Rental Coordinator	Coordinator at the rental department
Fleet Finance	Financial overview of the entire fleet
Fleet Manager	Operation fleet manager
Rental Manager	Manager at the rental department
Rental Representative	Sales representative at the rental department
Rental Sales Clerk	Sales representative at the rental department
Service Coordinator	Coordinator at the service department
Service Planner	Service planner
Technical Administration	Manager of the service department
Technical Manager	Technical manager at the service department
Transport Manager	Manager of the transport department
Transport Planner	Transport planner
Workshop Employee	Employee at the workshop
Workshop Manager	Manager at the workshop
DynaRent Field Service Engineer	For employees using the Field Service App
Customer Portal Integration User	For the user account used for Portal integration





## 9. Breaking changes

The two Power Platform products, DynaRent Mobile app, and DynaRent for D365 Sales, are provided as managed solutions. You can customize them to meet specific needs, creating an additional solution known as an unmanaged solution in Power Platform terminology.

However, it's important to note that due to changes in our product, unmanaged solutions might stop working. If a third party has added these solutions, they will be responsible for resolving any resulting issues.

Furthermore, unmanaged solutions can block the visibility of new functionality to users since managed solutions are restricted by the presence of unmanaged solutions. To grant users access to this new functionality, the unmanaged solution will either need to be removed or extended with the new features.

### 9.1 Deprecation of the DynaRent Mobile App

Embracing the dynamic landscape of Microsoft technology, we are proactively future-proofing our Mobile app to meet and exceed the evolving expectations of our valued customers.

In our commitment to continuous improvement, we are not only introducing new and exciting functionalities but also enhancing performance and refreshing the user interface.

This has resulted in new available Rental Mobile Operations apps in which even Microsoft Copilot Highlights on Notes is seamlessly integrated, a powerful AI-tool. For more information on the new Rental Mobile Operations app, see the associated release notes.

As we're focused on new Rental Mobile Operations apps, we won't be making any changes to the current version, change requests may be requested but will only be considered for the new Rental Mobile Operations app.

The current(old) mobile app will be discontinued as part of the July 2025 release and will not be supported anymore after this release. Any issues found after this release will not be addressed and as the app is not customizable, issues cannot be solved by customization.

Until the July 2025 release the current(old) mobile app will be validated against our releases to ensure it continues to operate accordingly. Any urgent issues (Prio 1 release defects) will still be addressed until the July 2025 release. Releases for the current(old) mobile app will only be released on request.



## 10. Deprecations

*Refer to the installation guide for technical details.*